

Splash Guard for C-CC20/TD

P/N 245915

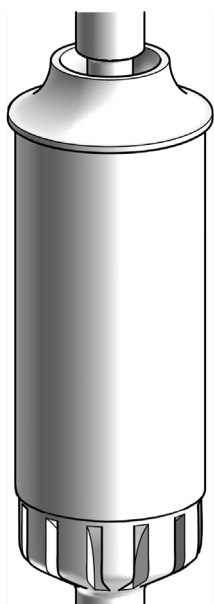
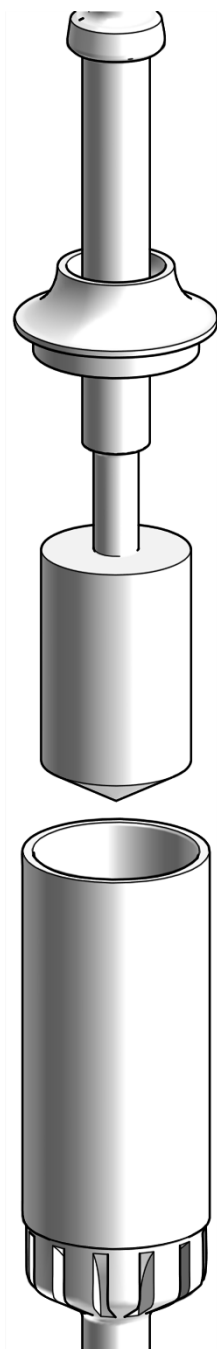

The Splash Guard for C-CC20/TD is intended to be placed onto the cup to prevent sample from splashing out of the cup when it is rotating at higher speeds.

To mount the splash guard, proceed as follows:

1. Before mounting the upper measuring system to the quick coupling slide the splash guard over the shaft of the upper measuring system.
2. After filling the sample, when the system is at measuring position, press the splash guard neatly into the upper rim of the measuring cup. Make sure the splash guard does not touch the upper measuring system.
3. Now you can start the measurement.

Notice: The splash guard is made of silicone. Check material compatibility accordingly.

Temperature Range: -40 °C to 200 °C. Do not use outside this range!